

F6

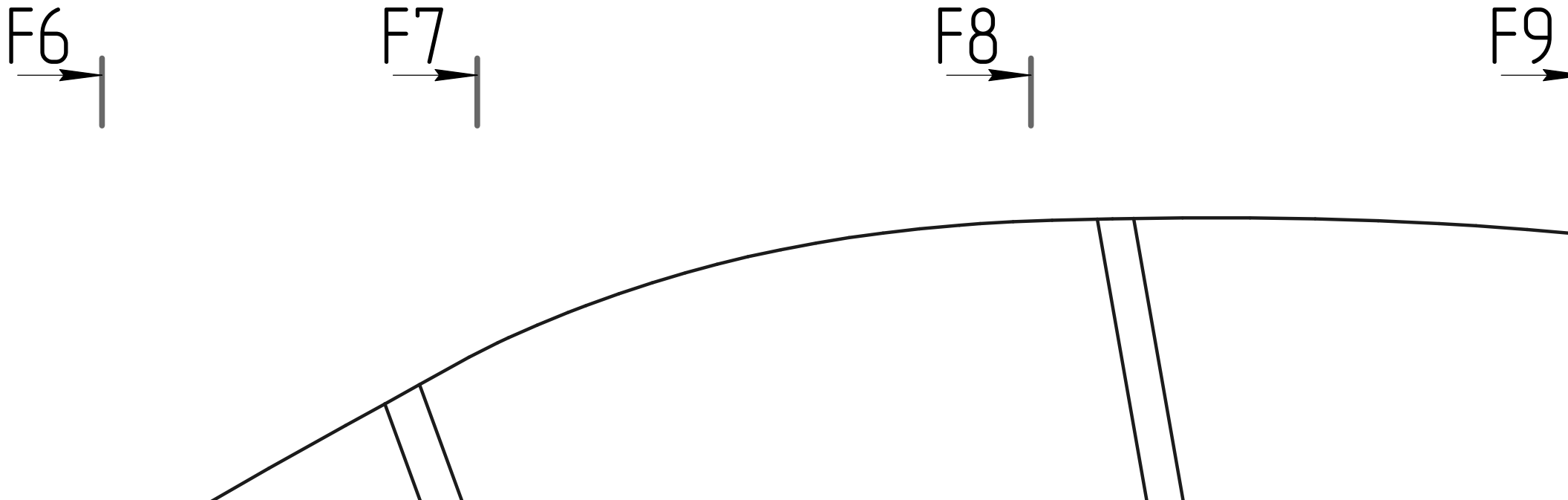

A diagram showing a curved structure, possibly a beam or a part of a machine, with four forces labeled F6, F7, F8, and F9. Each force is represented by a horizontal arrow pointing to the right, with a vertical line segment at its tip. The forces are applied to the upper surface of the curve. The curve itself is concave up and has a slight dip in the middle. Below the curve, there are two sets of parallel lines, one on the left and one on the right, suggesting supports or guides.

F7

F8

F9

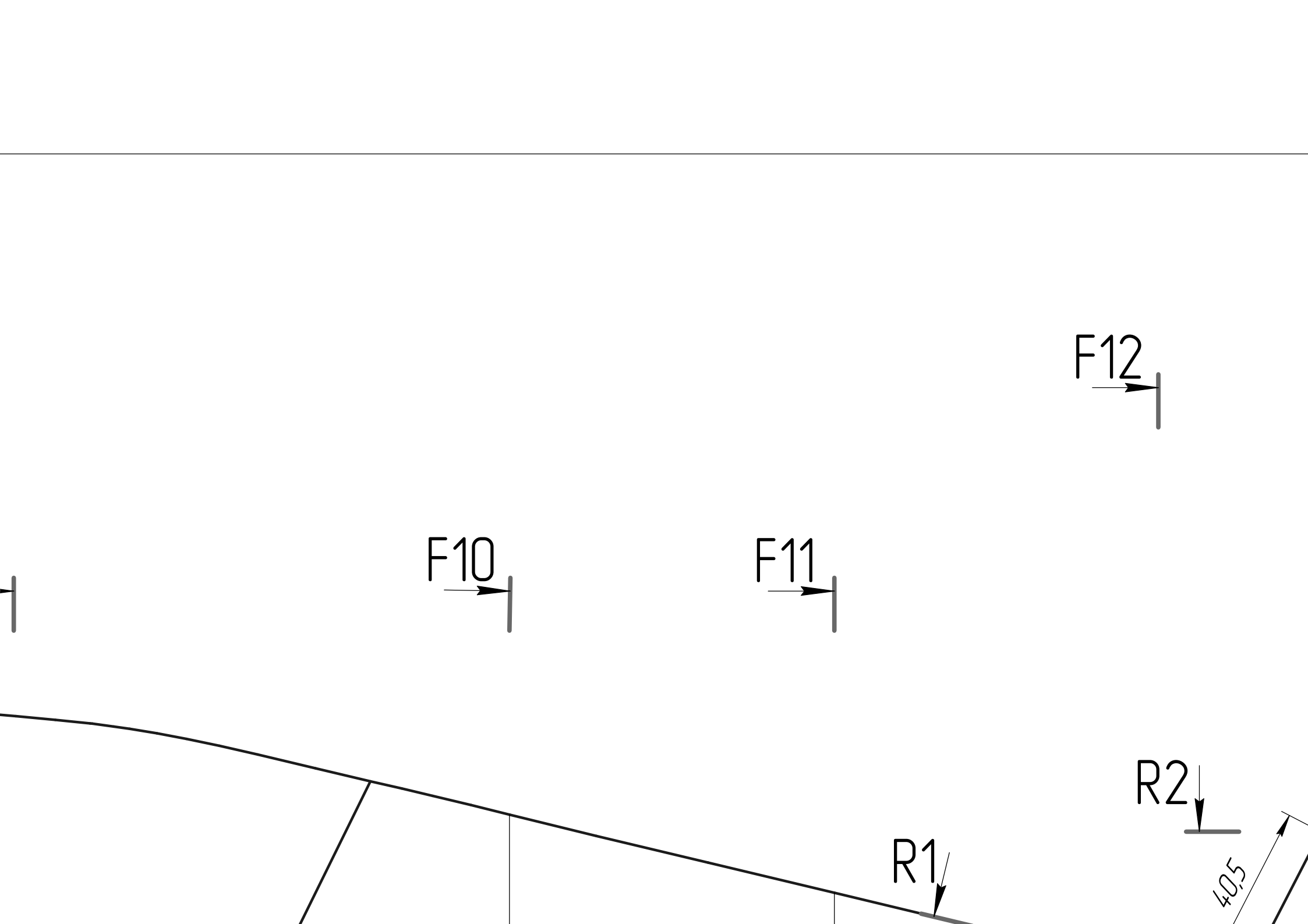

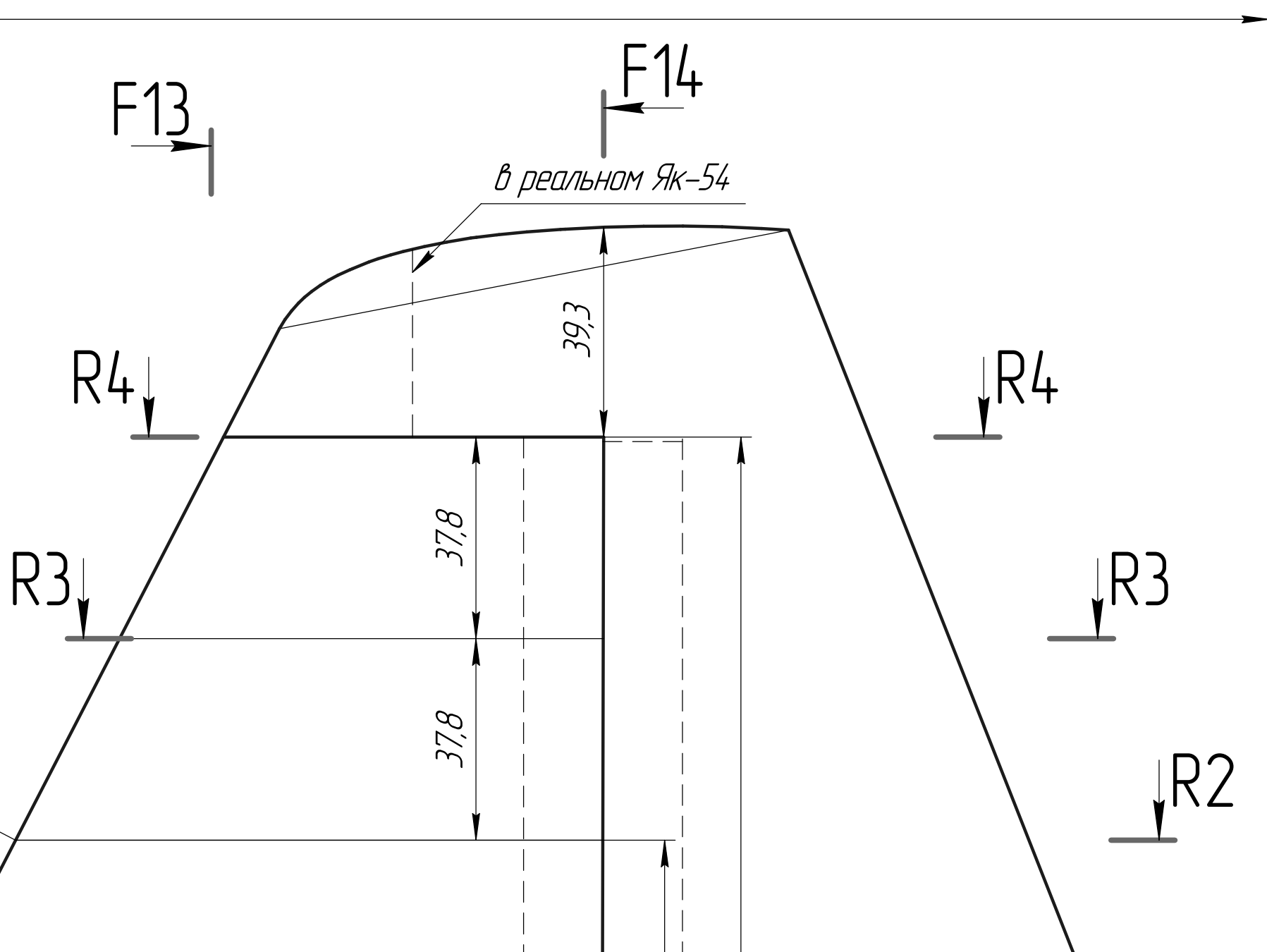

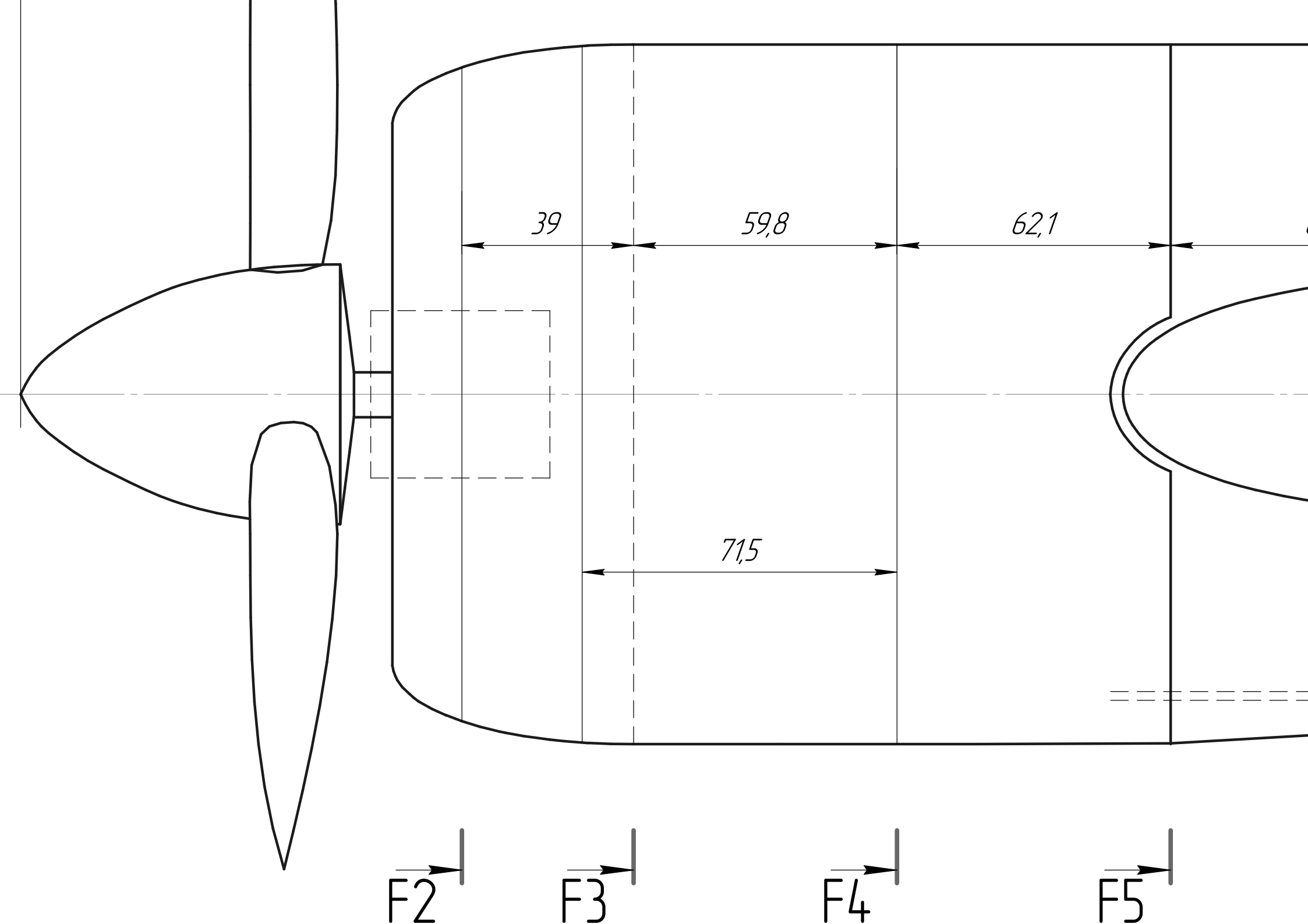

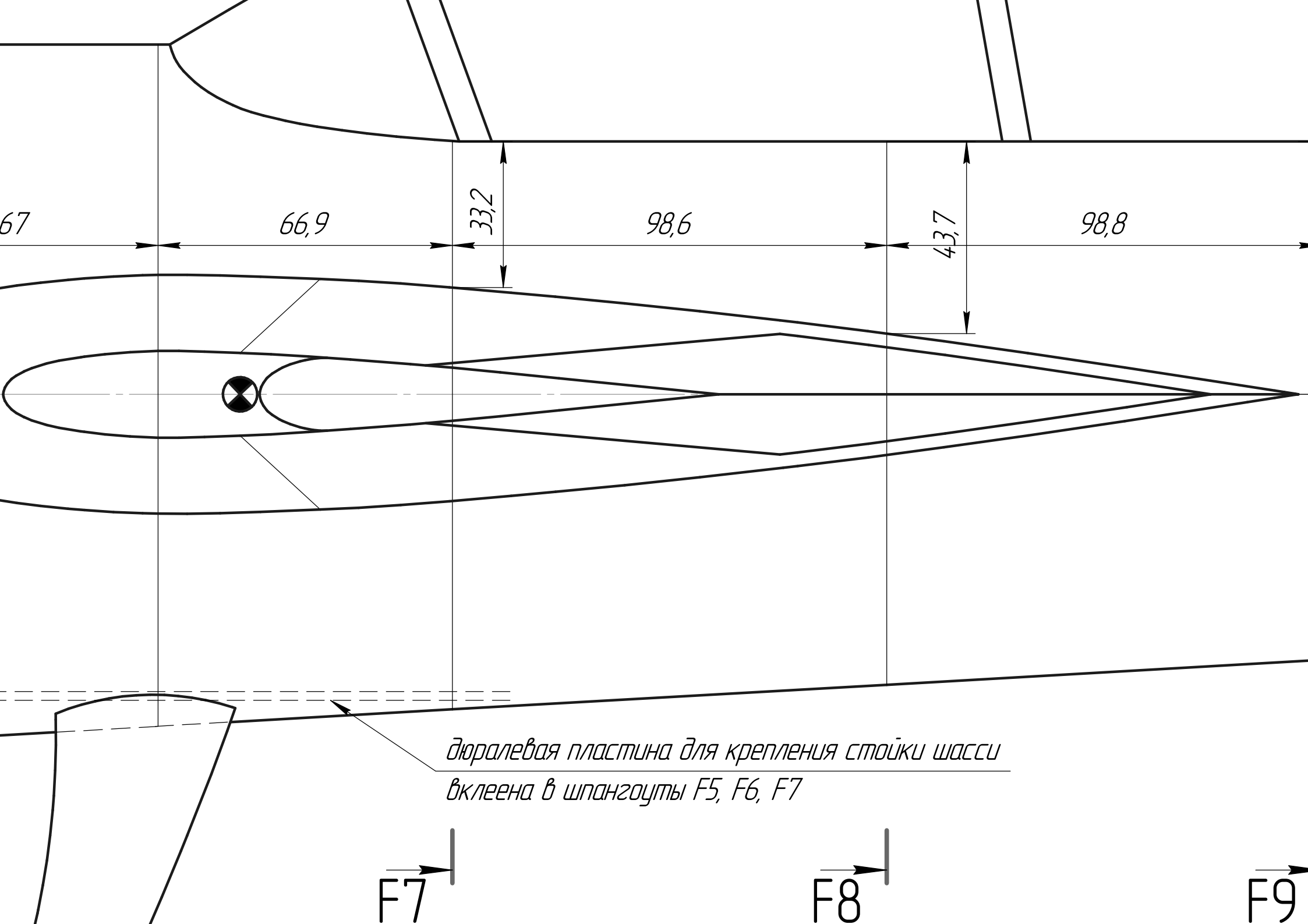

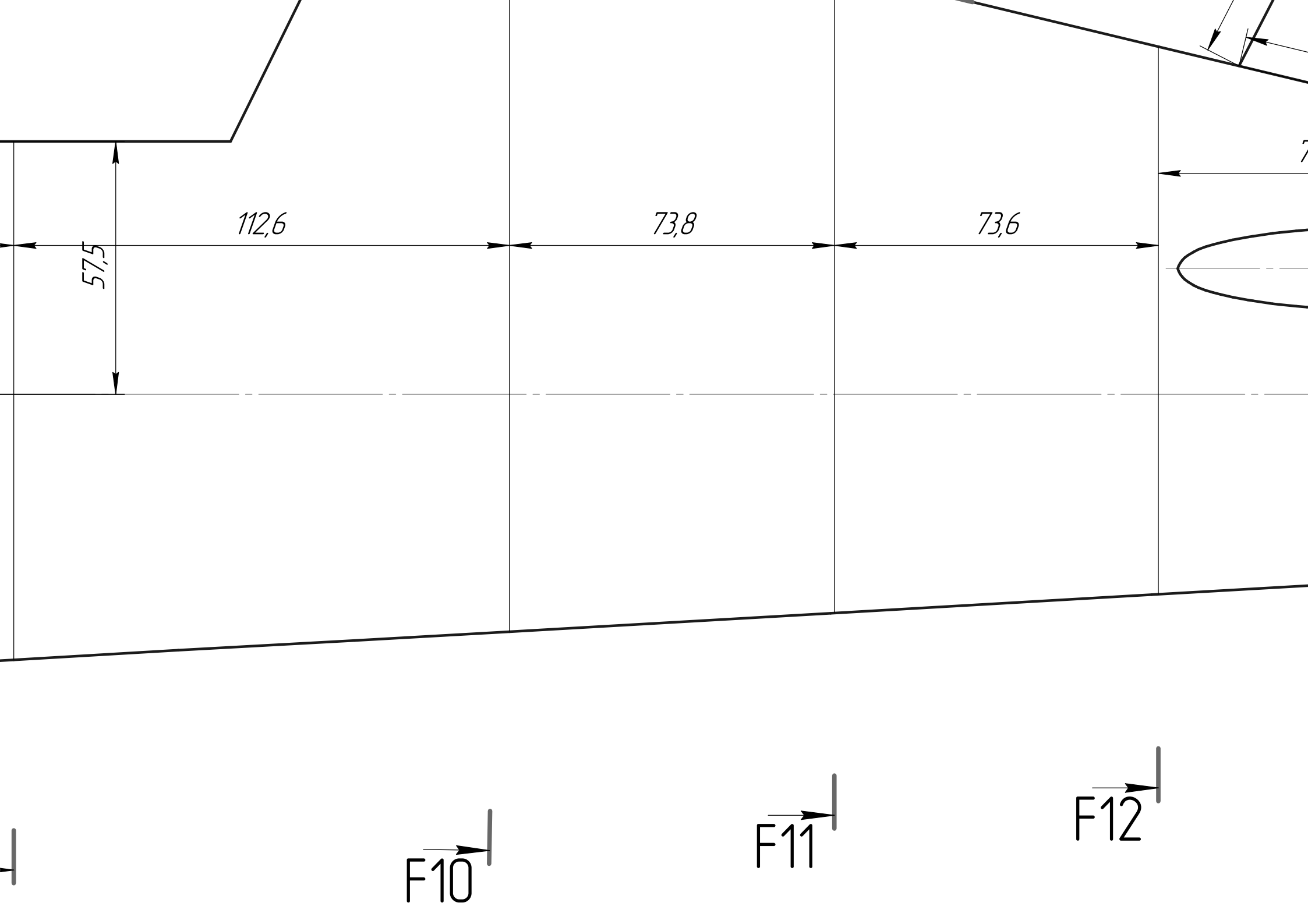

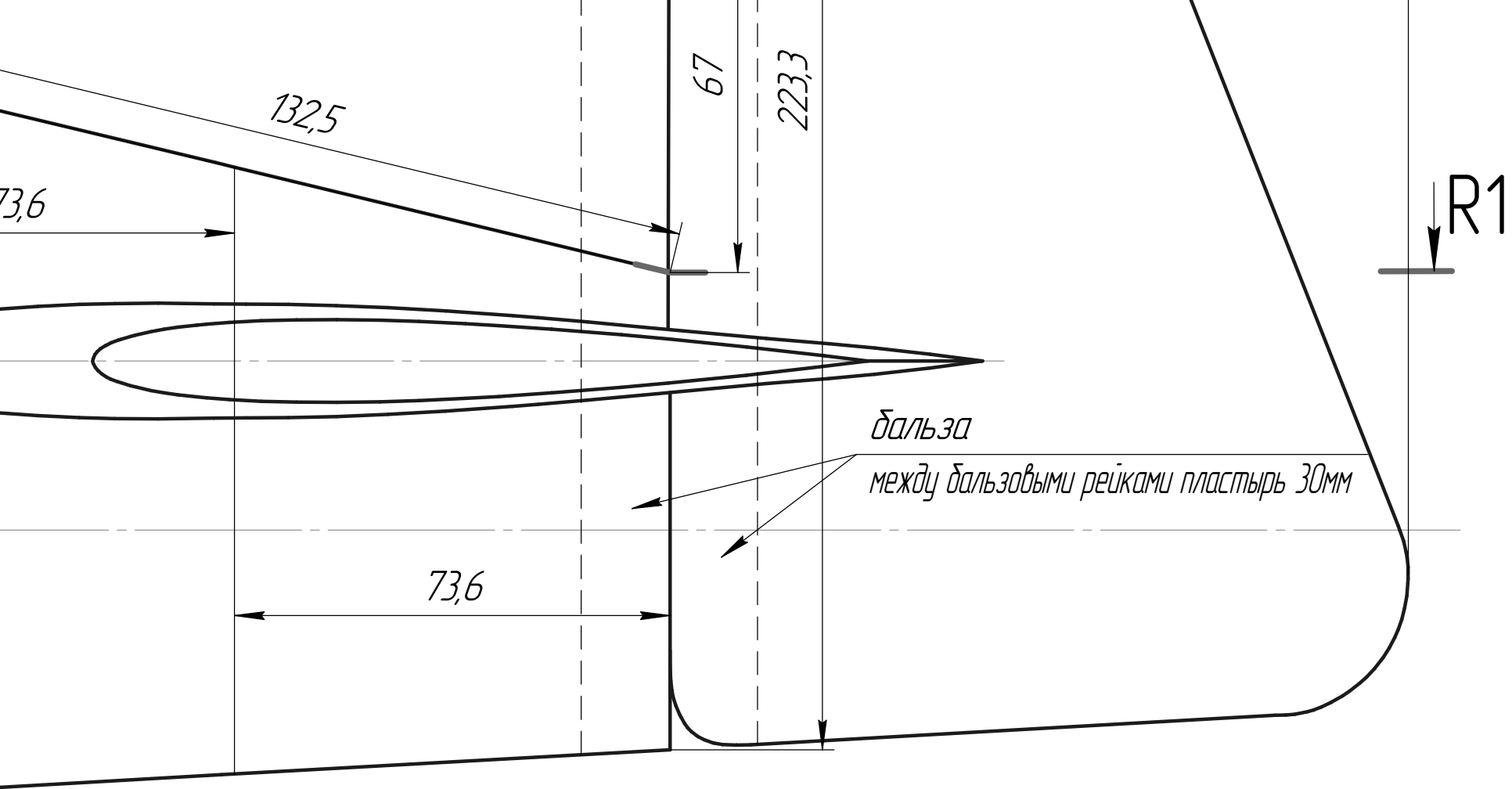

F13

F14

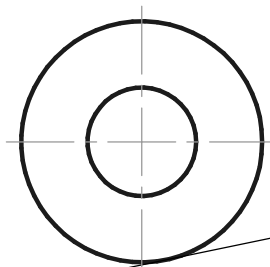

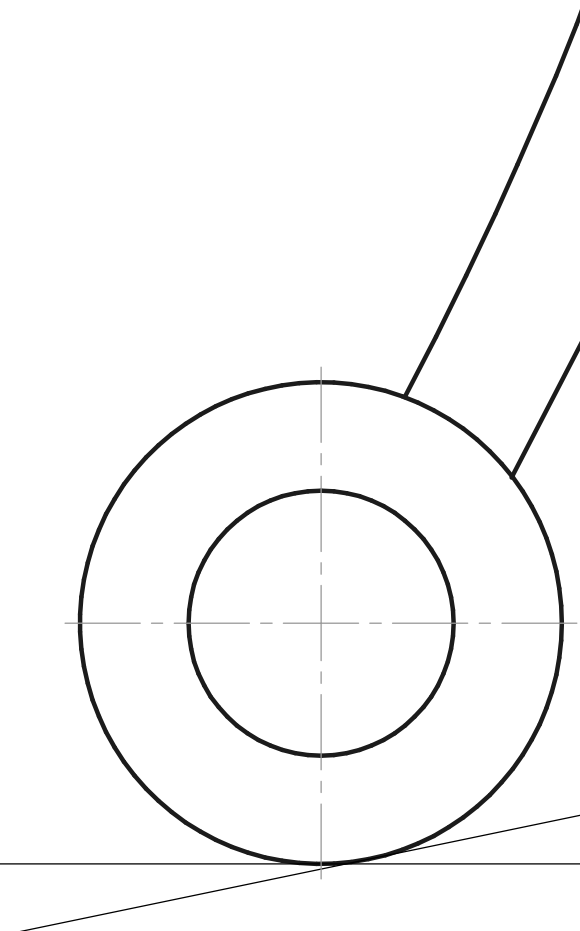
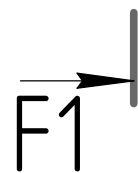

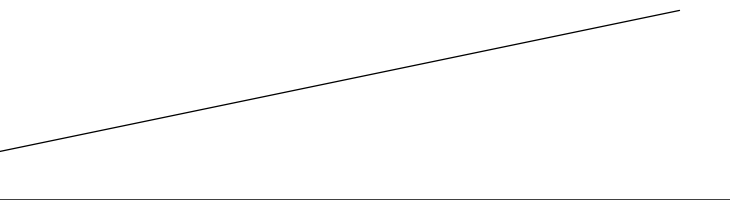
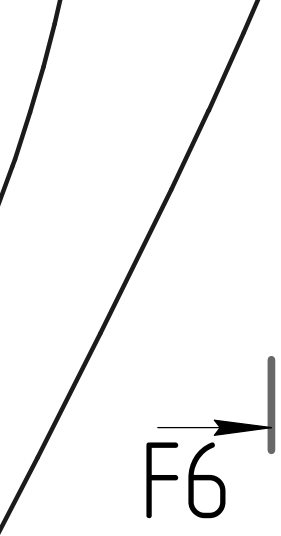

R4-R4

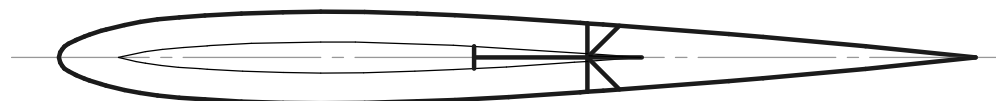

R3-R3

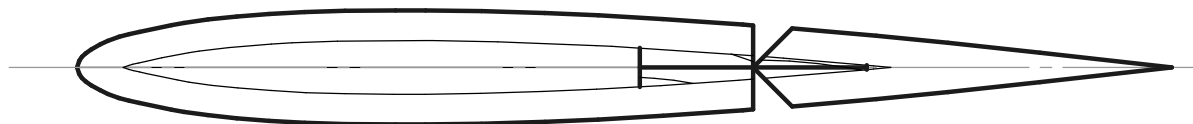

R2-R2

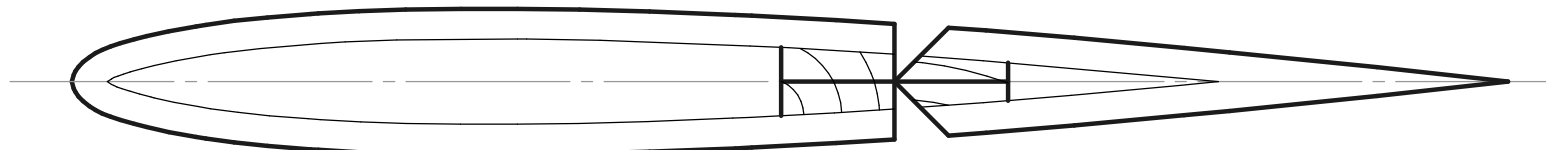

R1-R1

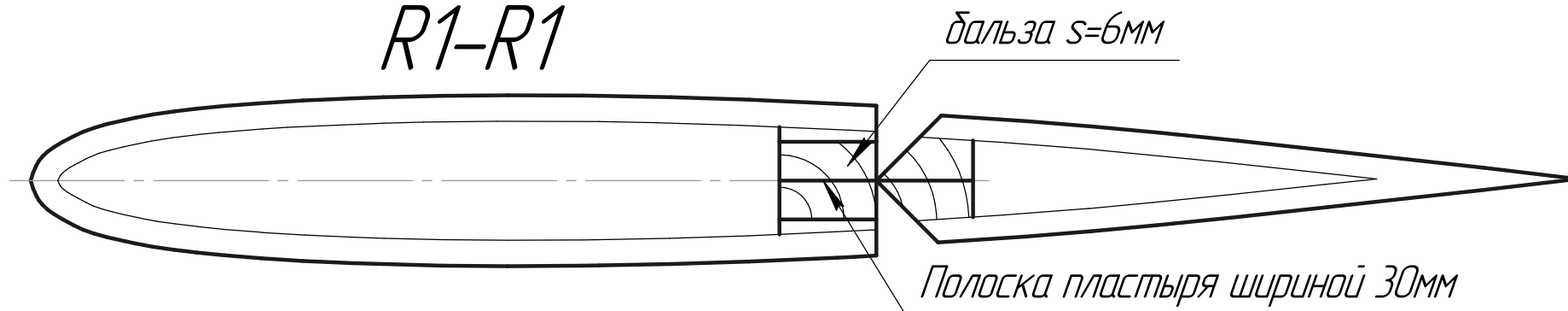

$F1-F1$

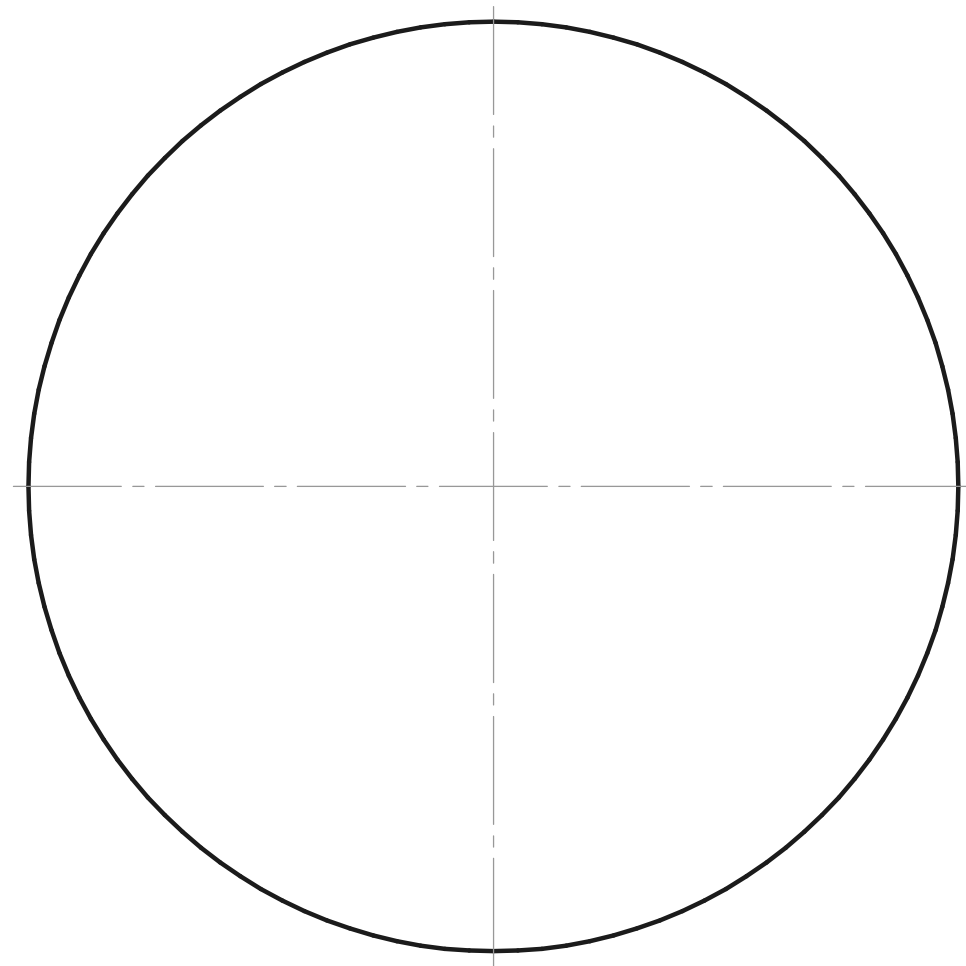

$F2-F2$

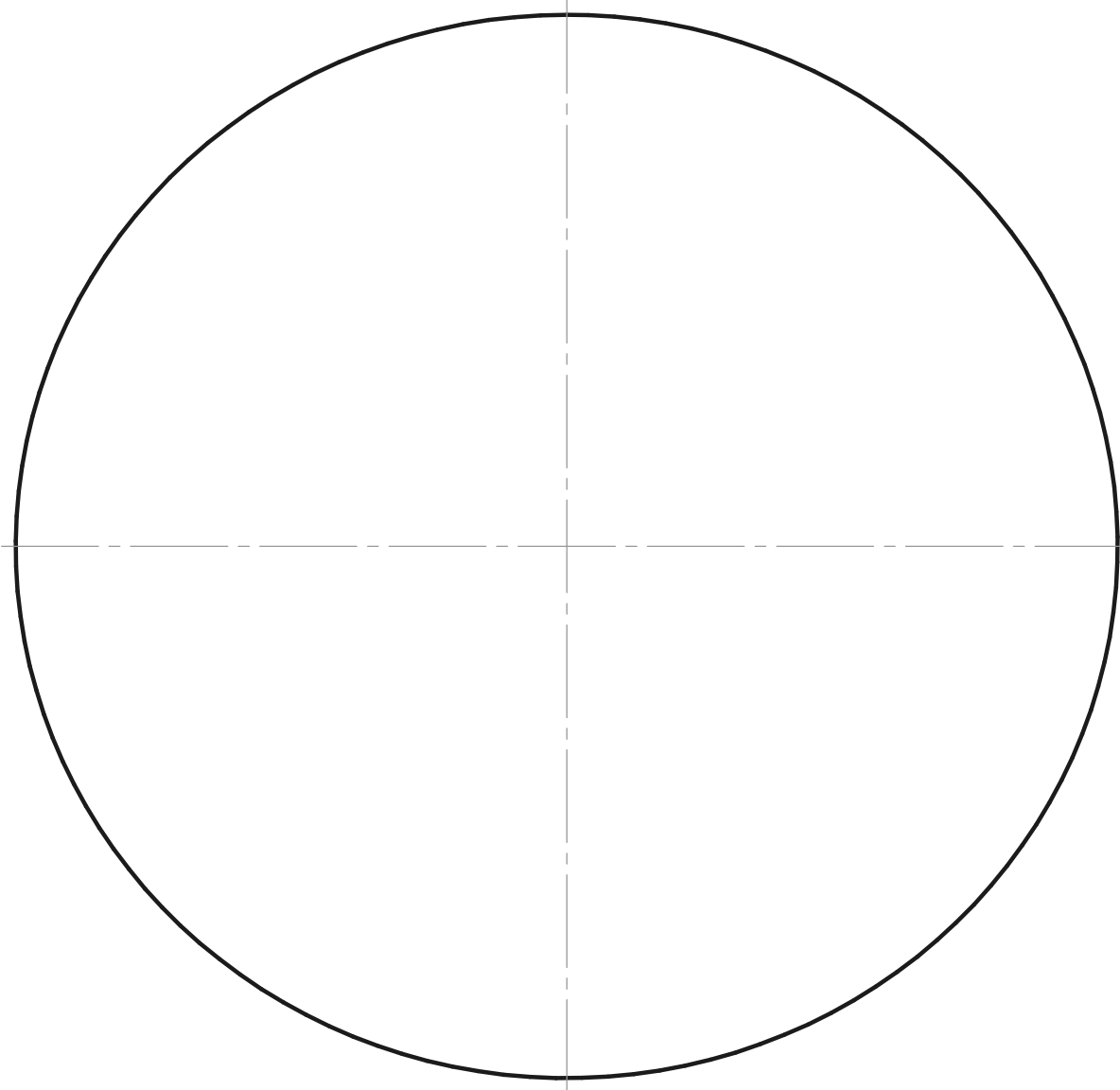

F3-F3

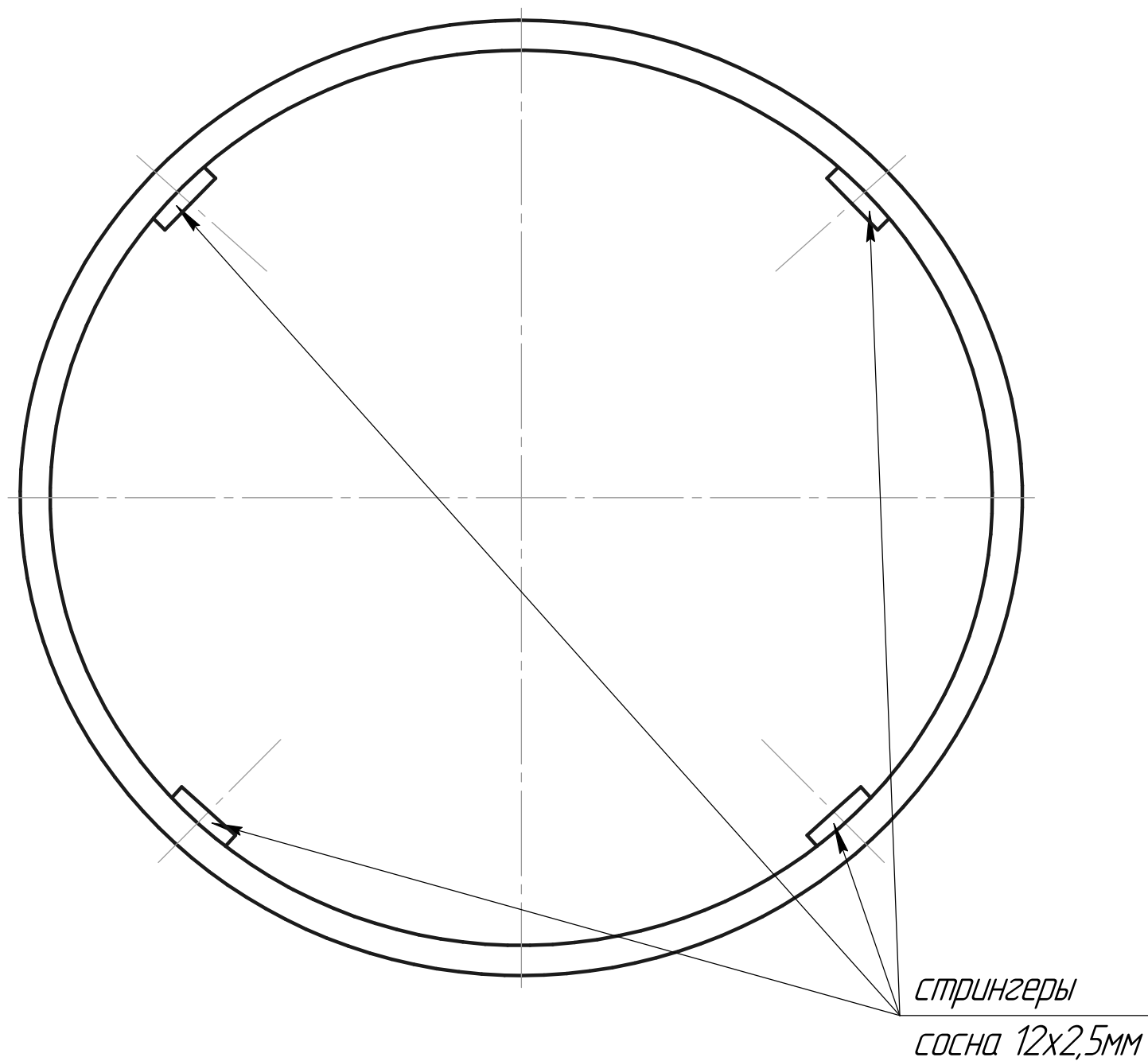

F4-F4

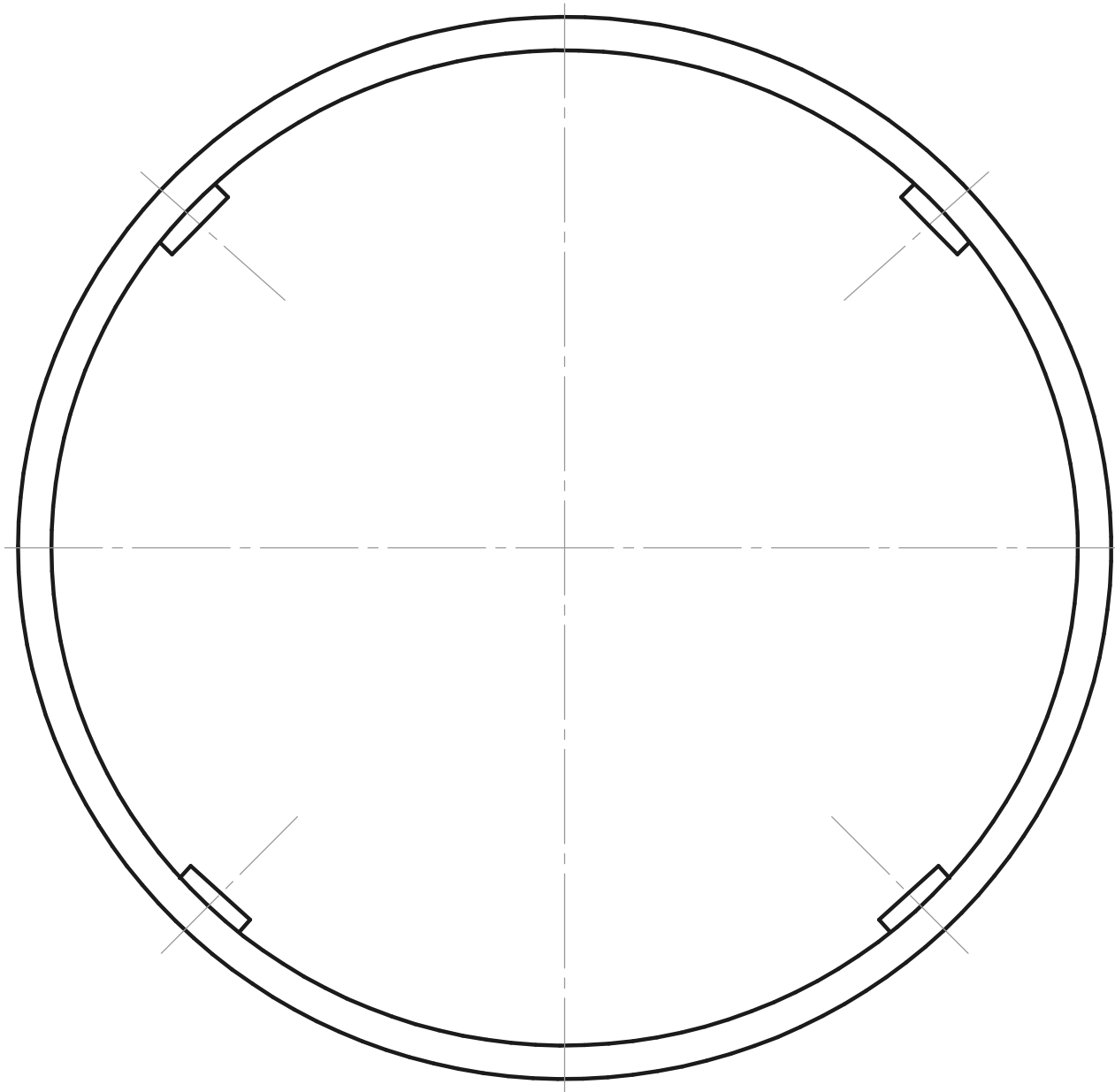

F5-F5

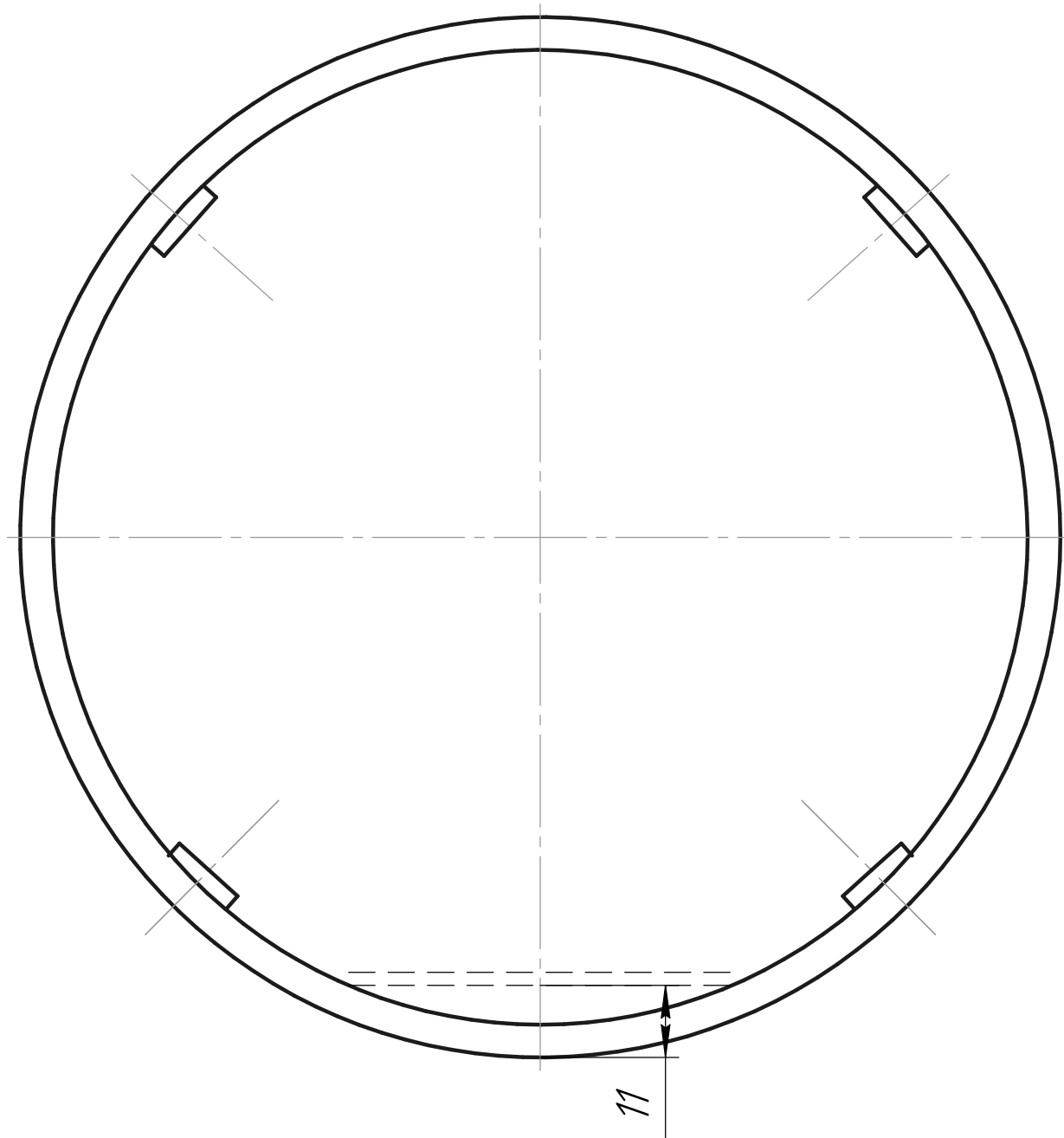

F6-F6

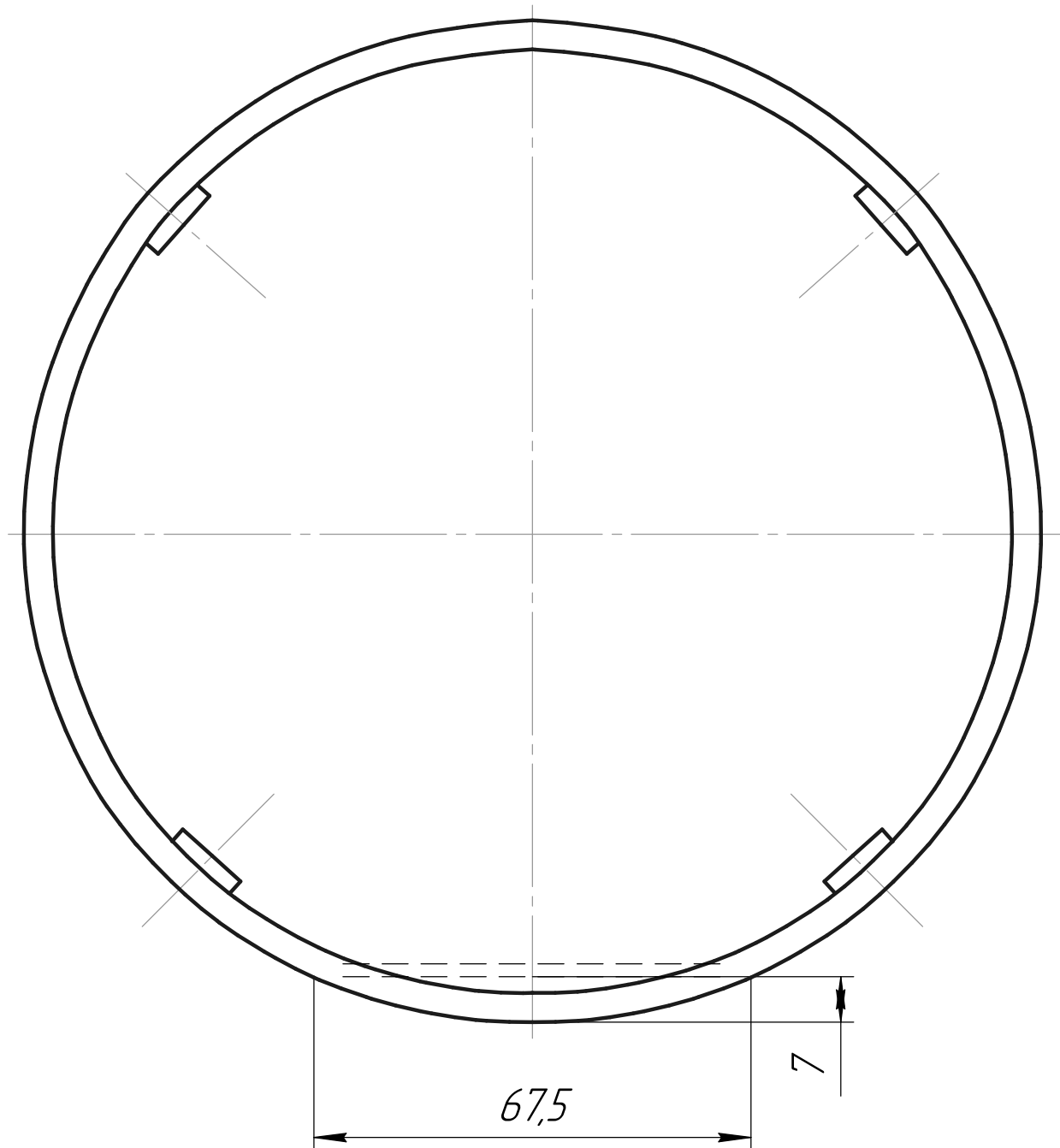

F7-F7

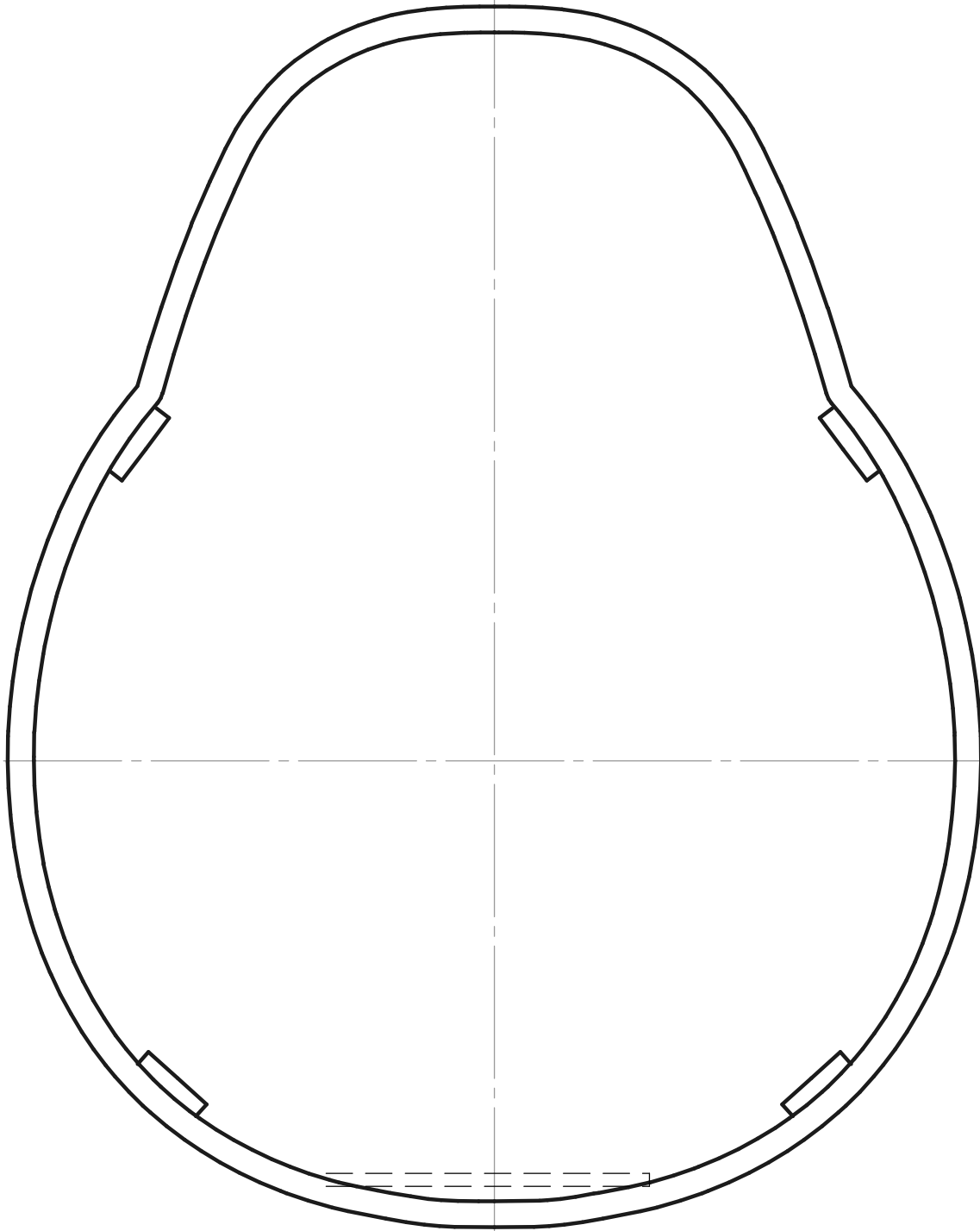

F8-F8

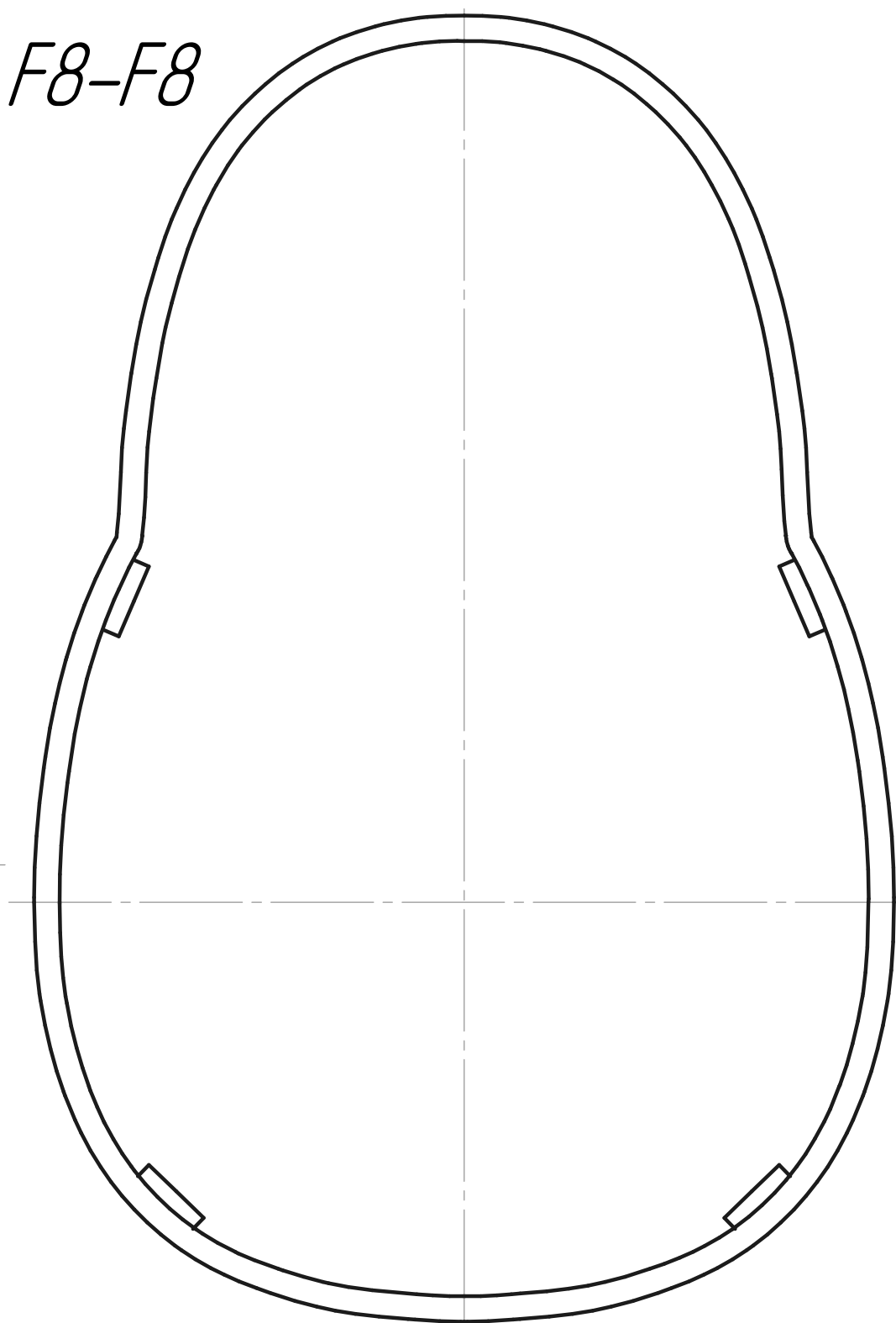

F9-F9

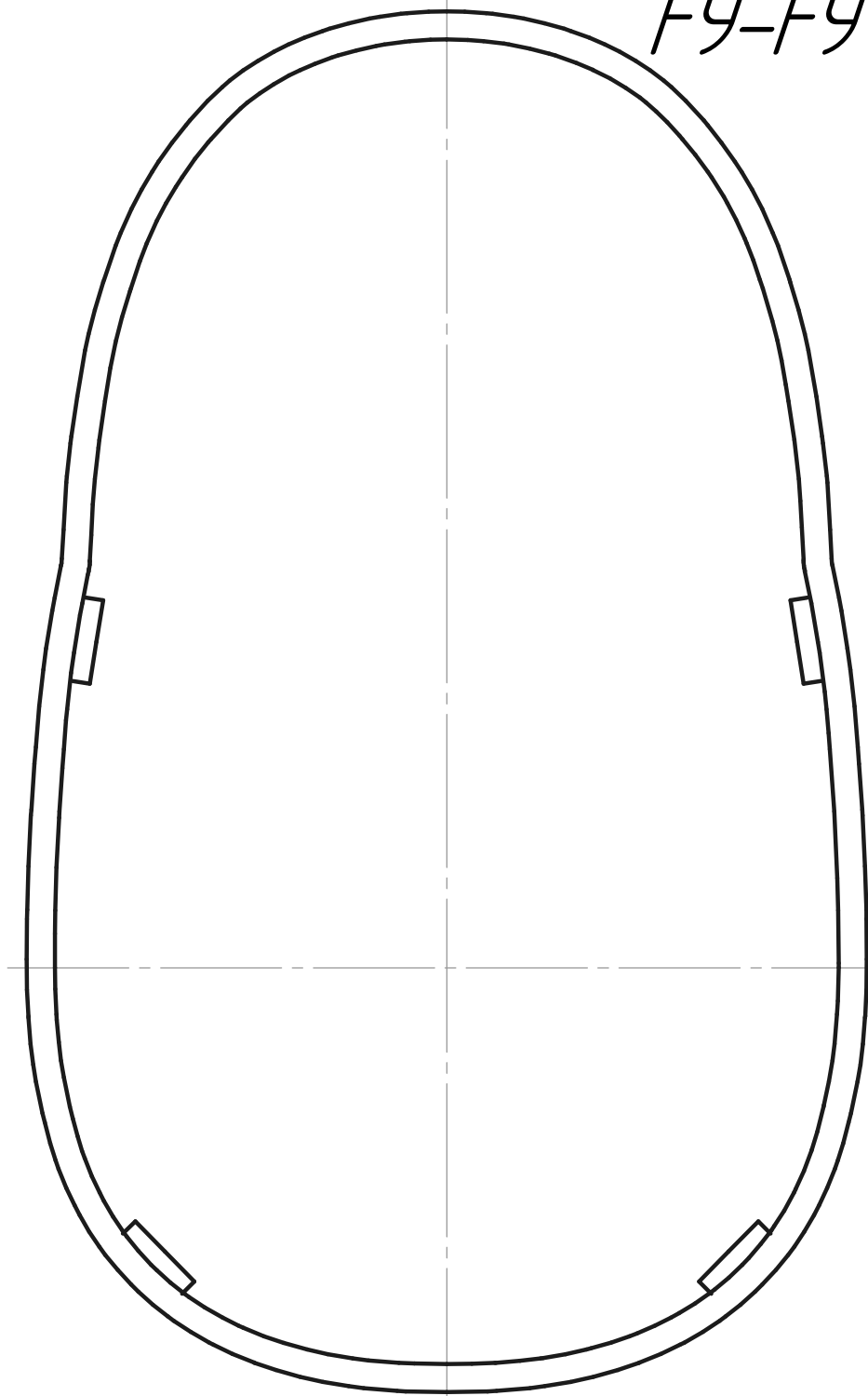

F10-F10

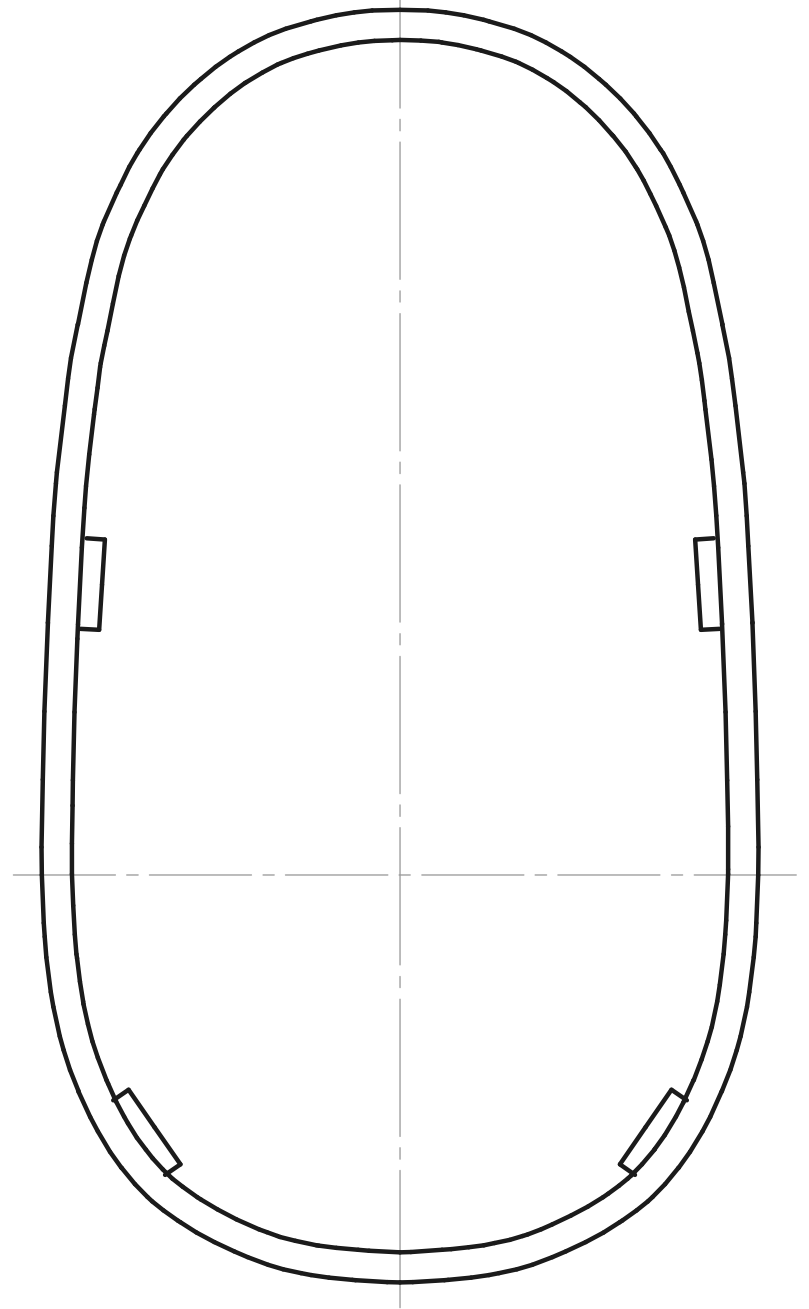

F11-F11

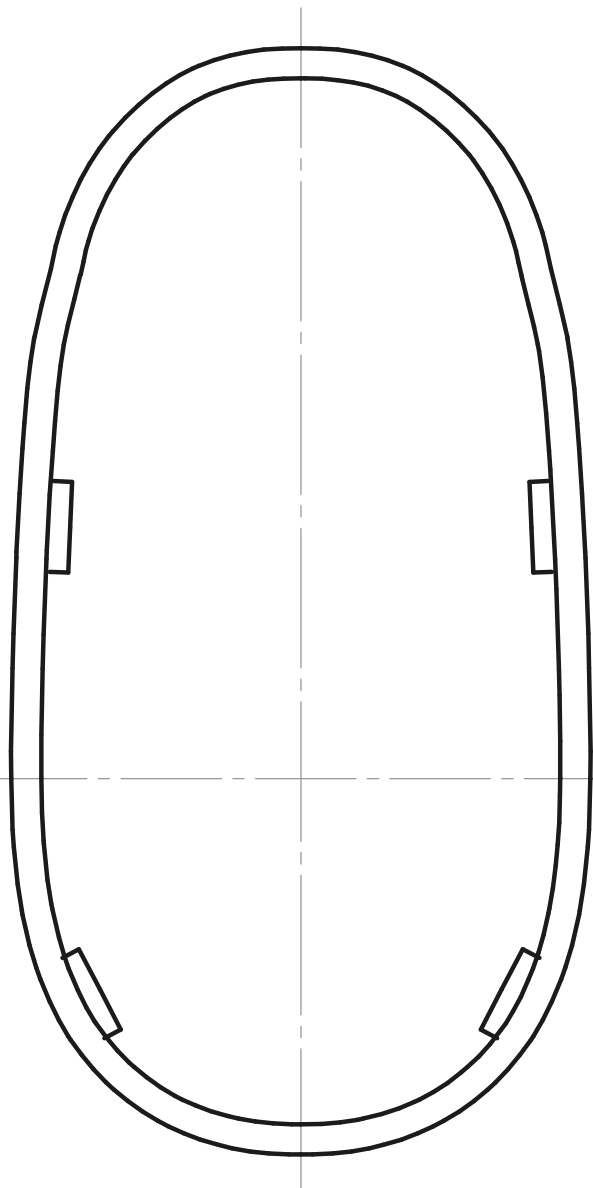

F12-F12

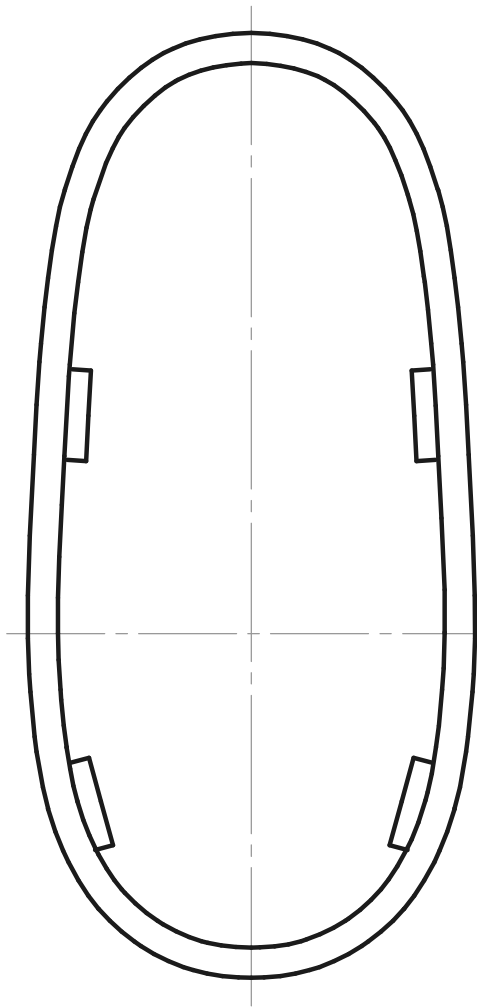

F13-F13

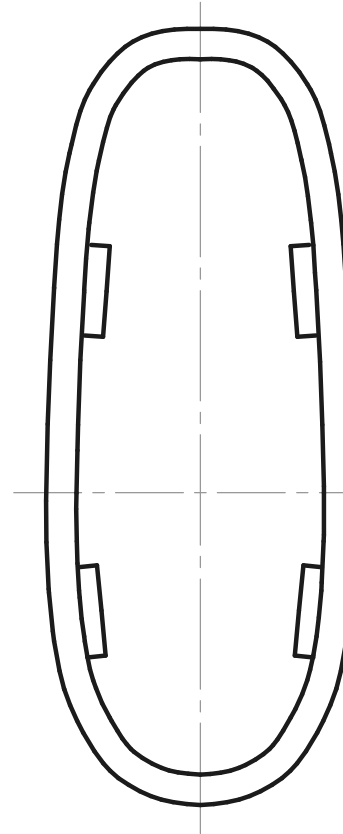

F14-F14

