

BULKHEAD

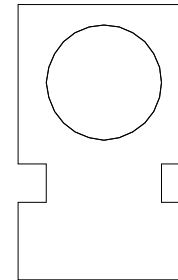

MOTOR MOUNT  
DOUBLER

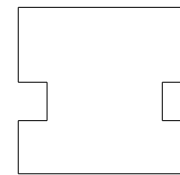

FUSELAGE OPENING DOUBLER - 2 REQ.

FUSELAGE OPENING DOUBLER POSITION

CANOPY CUT LINE

CANOPY SIDE - 2 REQ.

FUSELAGE



COUNT  
ER

MOTOR  
MOUNT  
1/16 PLY

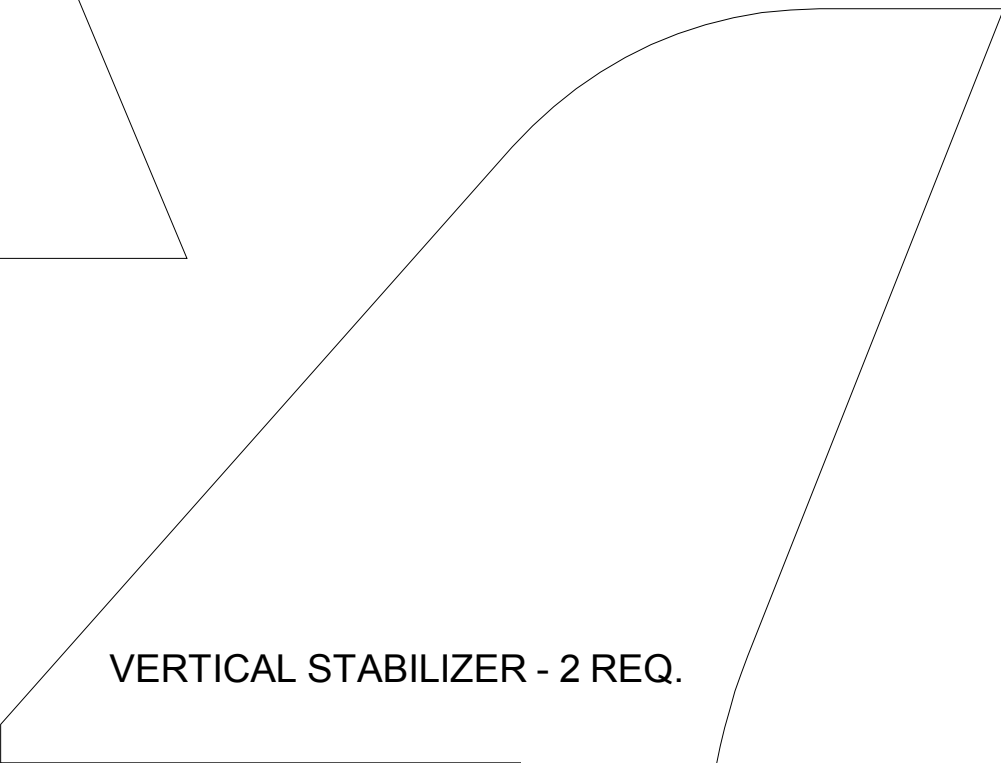

VERTICAL STABILIZER - 2 REQ.



FIN SIDE - 2 REQ.

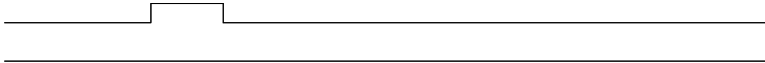

CNC CUT FOAM PARTS KITS ARE AVAILABLE  
THROUGH DZ1SFB ON RCGROUPS.COM





20.25

MAIN WING PANEL - 1 REQ.

R2 C1

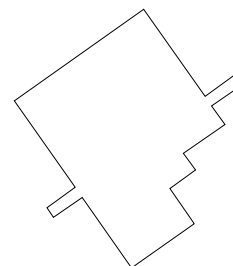
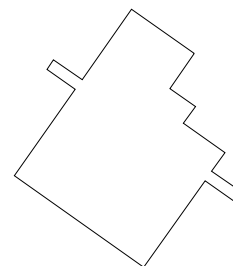

CENTER OF G

CUT PO  
AFTER AS  
TO ACHIE



OF GRAVITY

T POCKET FOR BATTERY  
ER ASSEMBLY AS NEEDED  
ACHIEVE PROPER C OF G.

CANARD SPAR POCKET  
FOR 2MM CF

4.50

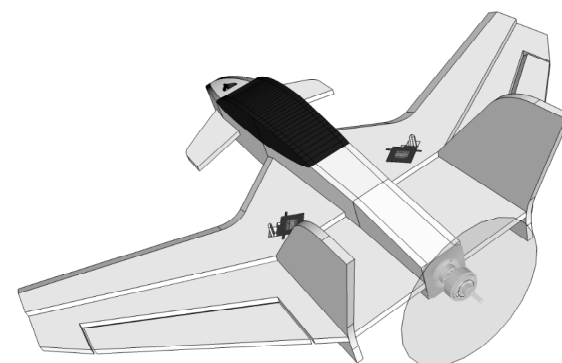
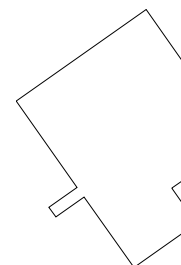

KF STEP  
PANEL - 2 REQ.

# PRIME JET 8 FSW

SPECIAL RECOGNITION GOES TO SCOTT  
A.K.A. PRIME 8 FOR THE INITIAL PLANS  
FOR THIS MODEL, AND TO BILLWHIT FOR  
REDESIGNING THE MODEL AT THIS  
SIZE. BOTH ARE RCGROUPS.COM  
MEMBERS.

CAD WORK BY KEN'S CAD MODELS  
A.K.A. DZ1SFB ON RCGROUPS.COM  
FOR NON COMMERCIAL USE ONLY  
RELEASED 17-NOV-2010

## EQUIPMENT SPECIFICATIONS:

MOTOR; C20 2900 KV

PROPELLER: 4.75 X 4.75 APC

SERVOS: HXT 5G (2)

BATTERY: 1000 MAH 2S

## MATERIAL SPECIFICATIONS:

ALL MATERIAL IS DOLLAR TREE  
READIBOARD WITH PAPER REMOVED  
UNLESS OTHERWISE SPECIFIED.

DOW PROTECTION BOARD III,  
OR 5MM CELLFOAM 88 WILL WORK ALSO.

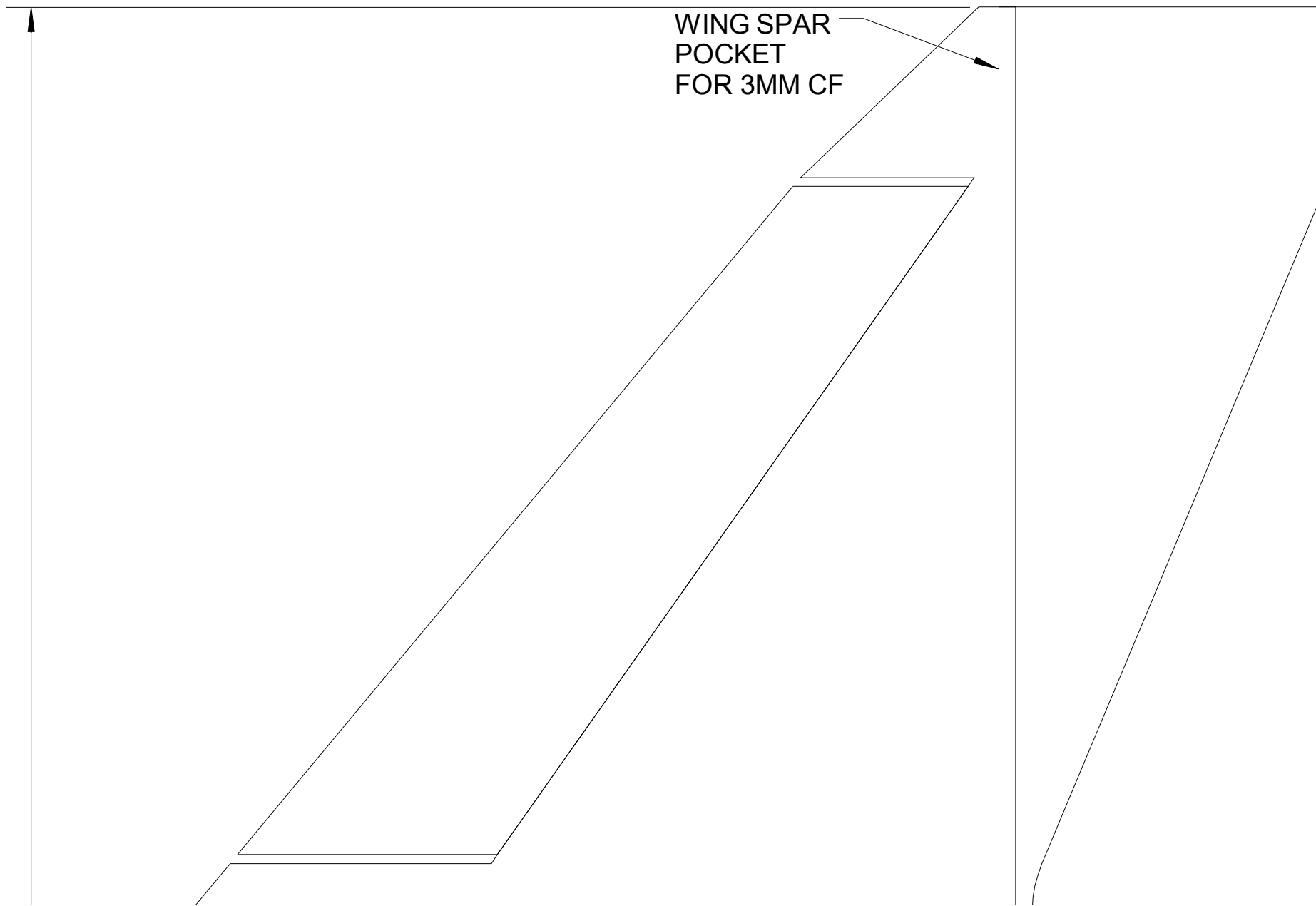

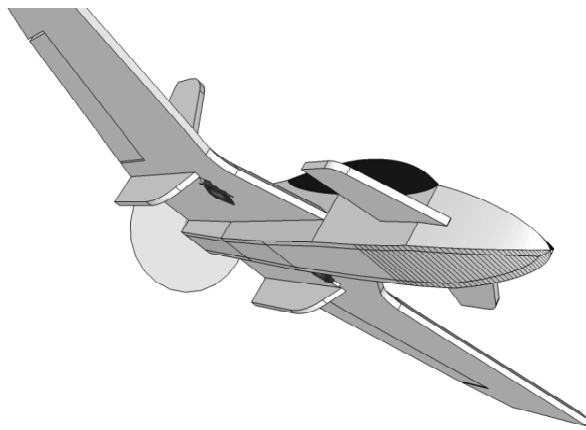

CANOPY MAGNET MOUNT - 1 REQ.

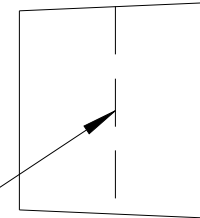

REAR EDGE OF CANOPY

FUSELAGE UPPER REAR PANEL - 1 REQ.

FUS



CANOPY RETENTION TOUNGUE - 1 REQ.

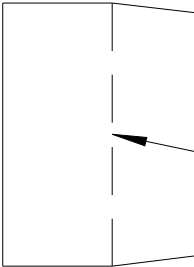

FRONT EDGE OF CANOPY

CANOPY UPPER PANEL - 1 REQ.

FUSELAGE UPPER  
FRONT PANEL - 1 REQ.

FUSELAGE LOWER PANEL - 1 REQ.

PRIME JET 8 FSW







R4 C3